

TASSO-M20

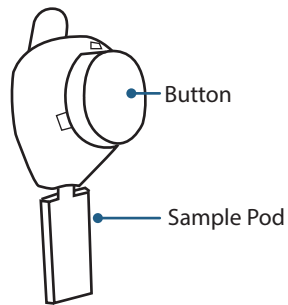

VIDEO

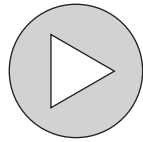

FIRST TIME USERS
Watch the demonstration video for how to use the device.

PREPARE

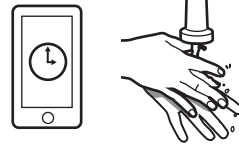

1. Get a timer and then wash hands. Healthcare workers must wear gloves during collection.



2. Rub child's arm **quickly and firmly** just below the shoulder. Rub until it's very warm to help blood flow.



3. Clean arm with alcohol pad.

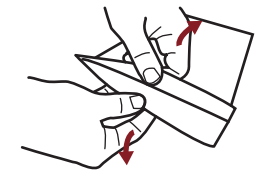

4. Open device pouch by pulling apart white and clear layers.

COLLECT

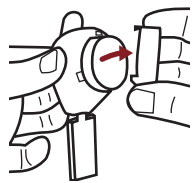

5. Remove clear plastic cover over the red button.

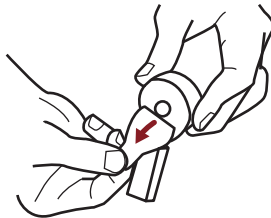

6. Peel paper tab behind the red button. Keep sample pod pointing down.



7. Stick device to child's shoulder. Do not remove once it's on.

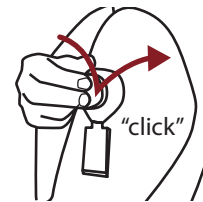

8. Press button quickly and firmly until it can't go any farther. Wait two seconds then let go.

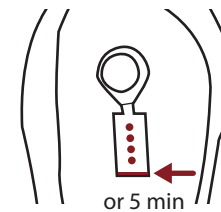

9. Start a five minute timer. Keep the child upright with arm hanging at their side. Watch dots fill. You will not see blood right away.

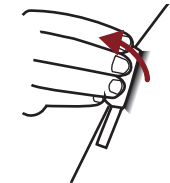

10. After five minutes or earlier if blood appears at the bottom of the pod, peel off device.

RETURN



11. Peel off the clear film to expose the sample pod vent. Apply barcode label to back of pod if provided.



12. Place device in the foil return bag and seal. Leave the moisture packs in the bag.

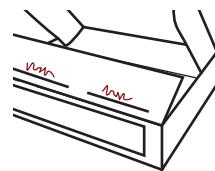

13. Write collection date and time on the inside flap of the box.



14. Place bag in box and seal with the strip.



15. Follow provided instructions to return your sample to the lab.

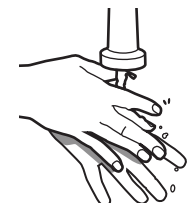

16. Wash hands after use.

TASSO ONDEMAND

TASSO-M20

For investigational use only.

 Contact us for help:
1-408-708-8451



INTENDED USE
The Tasso-M20 is used to collect, store, and transport capillary blood for testing in a centralized laboratory.

DEVICE DESCRIPTION

The Tasso-M20 is a sterile, disposable, integrated collection device. It consists of a Button and Sample Pod. The Button is covered by a removable cap. A peel off paper back is removed prior to sampling. After collecting the sample the device will be delivered to a centralized laboratory for analysis. A return bag with absorbent pad is provided in the kit.

STORAGE AND STABILITY
The Tasso-M20 should be stored at room temperature 18°C – 28°C (64°F – 82°F) and can be used until the expiration date. The samples are shipped at ambient temperature using the provided shipping materials.

PRINCIPLES OF OPERATION
When collecting a sample, the device is placed onto the skin of the upper arm for a couple of minutes. A sterile needle punctures skin and the Button draws capillary blood into the Sample Pod using vacuum. After a pre-defined time period or when the Sample Pod is full, the device is removed and delivered to the laboratory. Follow the detailed instructions during use.

KIT CONTENTS

- Tasso Blood Collection Device
- Alcohol Wipe
- Bandage
- Return Bag with Absorbent Pad
- Instructions for Use

CONTRAINDICATIONS

- Not for use on infant heels.









DISPOSAL

Defective devices to be disposed of according to local or state guidelines for disposal of used sharps.

CAUTIONS & WARNINGS

- Prescription use only.
- For In Vitro Diagnostic Use.
- Do not resterilize.
- Do not use if pouch has been opened or damaged.
- Do not use after expiration date.
- Single use only.
- Minor bruising may occur around the sample collection site.
- Use while seated as fainting may occur with any blood sampling procedure.
- Observe universal biological risk precautions.
- Keep out of reach of children.

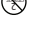
SYMBOLS

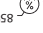
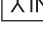
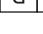
-  Catalog number
-  Lot number
-  Use by date
-  Consult instructions for use
-  This device contains sharps
-  Do not use if package is damaged
-  Single use only
-  Do not resterilize
-  Biological risk
-  Store at 18-28°C
-  Transport at 25-85% RH
-  Prescription use only
-  Sterilized by irradiation