

Tasso-M20



Research
Use Only

Click. Collect. Done!

Blood collection made easier than ever.



Improve the Patient Experience

Collecting samples with Tasso-M20 is convenient and virtually painless for patients.



Seamlessly Integrate with Clinical Trials

Tasso-M20 fits into your existing clinical trial workflow with the flexibility to support remote or in-clinic collection.



Accurately Measure Blood Analytes

Tasso-M20 collects volumetrically controlled dried blood samples that are clinical grade and stable for shipping.

Collection Process

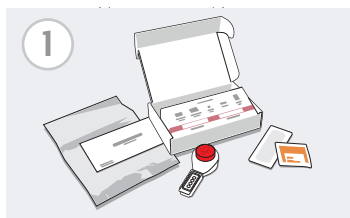

1 Patient receives a kit containing a Tasso-M20 and all the supplies for sample collection.

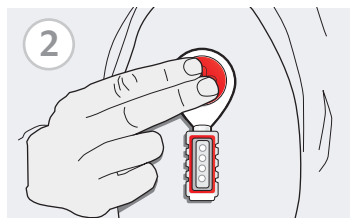

2 Patient collects samples at home without the need for access to a laboratory or mobile phlebotomist.

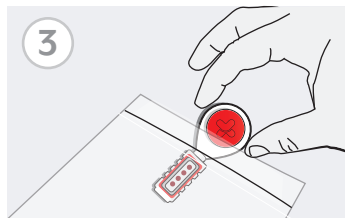

3 Patient places sample in packaging appropriate for blood transport under local regulations.



4 Patient returns sample for analysis via logistics method of choice.

Tasso offers end-to-end fulfillment and service logistics to support Tasso-M20 sampling programs.

Technical Specifications

Device Indications for Use: The Tasso-M20 is used to collect, store, and transport capillary blood for testing in a centralized laboratory. For Research Use Only. Not for use in diagnostic procedures.

Sample Type: Whole dried blood

Blood Collection Volume: 4 samples of 17.5 μ L, CV of <5%

Blood Collection Substrate: Tasso Volumetric Tip

Collection Time: 5 minutes

Drying Requirement: Separate drying step not required. Sample can be shipped immediately after collection.

Kit Dimensions: 6.75x4x1.4in (17x10x3.5cm)

Kit Weight: 3.4oz (100g)

Shipping: Kits may be delivered with custom return labels with no patient identification. Sample ships via standard post such as USPS.

Device Storage: 64.4-82.4° F (18-28° C)

Device Transport: Transport at 25-85% RH

Shelf Life: 12 months

Availability: CE Marked, Research Use Only in the United States



Safety Specifications

Biocompatibility: ANSI AAMI ISO 10993

Sterilization: ANSI AAMI ISO 11137
ANSI AAMI ISO 11607

Please visit www.tassoinc.com/tasso-m20 for more information.